



# CUSTOM SOLUTIONS

**Cleans and  
Degreases at  
Mild pH Levels**

**Removes  
Stubborn Rubber  
Burn Marks**

**Contains  
No Section 313  
Chemicals**

**Apply Using Any  
Mechanical  
Cleaning Device**

# FUSION

## CONCENTRATED CLEANER/DEGREASER WITH D-MARK FOR OUTSTANDING RUBBER MARK REMOVAL

### Professional Recommendations

- Emulsifying surfactant system that effectively cleans greasy, oily soils and rubber tire marks
- This emulsification, along with the low foam properties of the product allow it to be used with any mechanical cleaning device
- Mild pH which makes it safer for employees to use than most industrial degreasers

### Specifications

Appearance	Clear, blue liquid
Odor	Citrus
Density (lbs/gal) (±0.1 @20°C)	8.90
pH (Conc.) (±0.5 @20°C)	10.0
Refractive index (±0.0020 @20°C)	1.3674
Flashpoint	None
Foam Generation	Moderate
Stability (40°-120°F)	Stable
Freeze/thaw stability	OK 3 cycles
Shelf life (Closed containers, 40°-120°F)	1 year minimum

### Equipment List

- ✓ Single disc floor machine or autoscrubber
- ✓ Wet vacuum
- ✓ Grit-type brushes for autoscrubber
- ✓ Deck brush
- ✓ Looped-end cotton mop
- ✓ Mop bucket with wringer
- ✓ Dust mop
- ✓ Scraper

Available in sizes:  
2.5, 55 gallon and tote containers.

Read all directions and cautions  
prior to beginning work.



Wear safety equipment recommended on MSDS. Read all directions and cautions prior to beginning work. Remove loose soil and garbage. Before cleaning floors, place Wet Floor signs near work area.

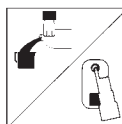

Dilute **Fusion** with water as follows:  
**General Cleaning:** 1:20 to 1:30  
**Floor with Tire Marks:** 1:10  
**Heavy Tire Marks** and Soils: 1:1 to 1:5  
**Note:** Using warm water when diluting **Fusion** will help to remove rubber tire marks more easily.



Apply to surface liberally while scrubbing. Allow to work. If soil is heavy, double scrub with an auto scrubber (First pass, squeegee up; second pass, squeegee down, vac on). Pick up as much solution as possible. If possible, allow floor to dry before traffic resumes on cleaned area.