



CUSTOM SOLUTIONS

Nonbutyl
Formula—Safer
for Employees
and the
Environment

Penetrates Tough
Soils Fast—Saves
Time and Labor

Contains No
Caustic

SAMSON

INDUSTRIAL HEAVY DUTY CLEANER and DEGREASER

Professional Recommendations

- Apply liberally to tough soils and allow to work
- **Use** regularly for peak performance
- Use "grit " type brushes on your autoscrubber to enhance cleaning on unfinished concrete and other industrial floors
- Overlap your cleaning passes to assure uniform cleaning and "double scrub" when heavy soil is present
- When mop cleaning, change cleaning solution frequently to get peak performance. Do not let mop rest in cleaning solution between uses
- If applying this product through a pressure washer, stay clear of mist

Surface Safety

- Safe on most industrial surfaces
- Before cleaning aluminum, brass, copper, or other non-ferrous metals, check for safety. If metal bubbles or darkens, do not use this product on that surface
- **NOT** recommended for glass

Specifications

Appearance	Clear, green liquid
Odor	Lemon
Density (lbs/gal)(±0.1 @20°C)	8.6
pH (Conc./1%)(±0.5 @20°C)	12.8/10.6
Refractive index (±0.0020 @20°C)	1.3545
Hard water tolerance (hardness as ppm CaCO ₃)	Greater than 3800 ppm
Total alkalinity (% CaCO ₃)	2.6
% Volatile organic compounds (VOC)	.6
Foam generation	Moderate
USDA rating	C-1
Stability (40°-120°F)	Stable
Freeze/thaw stability	OK 3 cycles
Shelf life (Closed containers, 40°-120°F)	1 year minimum

Equipment List

- ✓ Wet floor signs
- ✓ Autoscrubber with grit type brushes
- ✓ Wet vacuum
- ✓ Looped-end cotton mop
- ✓ Mop bucket and wringer
- ✓ Pressure washer
- ✓ Push broom

Available in sizes:

1, 2.5, 55 gallon and tote containers.

Wear safety equipment recommended on MSDS, place wet floor signs and read all directions and cautions prior to beginning work.



Wear safety equipment recommended on MSDS. Read all directions and cautions prior to beginning work. Remove loose soil and garbage. Before cleaning floors, place Wet Floor signs near work area.

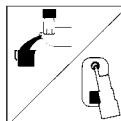

Dilute **Samson** with water as follows:
Super Heavy Soil: 1:1 (64 oz. per gallon)
Heavy Soil: 10:1 (13 oz. per gallon)
Moderate Soil: 20:1 (6 oz. per gallon)

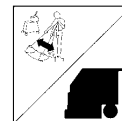

Apply to surface liberally while scrubbing. Allow to work. If soil is heavy, double scrub with an autoscrubber (First pass, squeegee up; second pass, squeegee down, vac on). Pick up as much solution as possible. If possible, allow floor to dry before traffic resumes on cleaned area.



For pressure cleaning: Draw concentrate directly from container. Set dilution using pressure washer manufacturer's directions according to soil present.