



900 East 103rd Street
Chicago, Illinois 60628
800.621.8553
Fax: 800.621.1276
www.nuancesol.com

FORMULA FOUR

STEAM & PRESSURE CLEANER

PATENTED DESIGN FEATURES

- **Positive emulsion** — spontaneously emulsifies greasy soil to improve cleaning — prevents soil/dirt redeposition
- **Heavy duty balanced alkaline builder blend** — enhances soil suspension, digests oil and grease, enhances rinseability — conditions cleaning water
- **Surface safety** — built-in corrosion inhibitor, anti-rust agent
- **Low scale formula** — to prevent alkali build up in hot and cold water pressure washers
- **USDA rating** — A-1

PROFESSIONAL RECOMMENDATIONS

- This is an excellent “catch-up” cleaner that will perform best when used regularly
- If applying with a pressure washer, stay out of mist
- Overlap your cleaning passes to assure uniform cleaning
- **Not** recommended for removal of baked-on or dried, hardened soils—use a cleaner that is solvent fortified

APPLICATION

Industrial heavy duty maintenance cleaner — floors, walls, machinery, hoods, sumps, vent systems through mechanical cleaning devices.

SPECIFICATIONS

Appearance: Clear, red liquid
Odor: Mild, characteristic
Density (lbs/gal)(±0.1 @20°C): 8.76
pH (Conc./1%)(±0.5@20°C): 13.5/11.7
Refractive index (±.0020@20°C): 1.3492
Hard water tolerance (as ppm CaCO₃): >8000 ppm
Solvent %: None
Flashpoint (TCC): None
USDA rating: A-1
Foam generation: Moderate
Stability (40°-120°F): Stable
Freeze/thaw stability: OK, 3 cycles
Shelf life (closed containers, 40°-120°F): 1 year minimum

DIRECTIONS



Wear safety equipment recommended on MSDS. Read all directions and cautions prior to beginning work.



For Pressure Cleaning: Draw concentrate directly from container. Set dilution using pressure washer manufacturer's directions according to soil present.

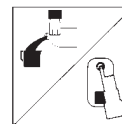

Dilute **Formula Four** with water as follows:
Heavy soil: 5:1 (26 oz. per gallon)
Moderate soil: 20:1 (6 oz. per gallon)
Light cleaning: 50:1 (2.5 oz. per gallon).

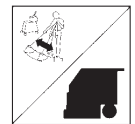

Apply to surface liberally while scrubbing. Allow to work. If soil is heavy, double scrub with an autoscrubber (First pass, squeegee up; second pass, squeegee down, vac on). Pick up as much solution as possible. If possible, allow floor to dry before traffic resumes on cleaned area.



Wear safety equipment recommended on MSDS, place wet floor signs and read all directions and cautions prior to beginning work.